

PEES Power Systems

Lifepo4 battery float voltage



Overview

The optimal float voltage for LiFePO₄ batteries typically ranges between 3. Manufacturers are required to ship the batteries at a 30% state of charge. In LiFePO₄ batteries, maintaining the correct float voltage is crucial. Incorrect float voltage settings can gradually reduce battery lifespan, even if no immediate failure occurs. This setting is particularly vital in applications with continuous power connections, such as solar power systems or uninterruptible power supplies. LiFePO₄ battery voltage refers to the electrical potential difference within Lithium Iron Phosphate batteries, a type of lithium-ion battery. This differs from traditional.

Lifepo4 battery float voltage



The Complete Guide to Floating Charge Voltage for 12V, 24V, & 48V

For standard 12V setups common in RVs, marine applications, or small-scale solar lighting, a float voltage of 13.5V is ideal. While some chargers default to 13.8V (lead-acid standard), ...

Guide to LiFePO4 Voltage Chart

LiFePO4 battery voltage refers to the electrical potential difference within Lithium Iron Phosphate batteries, a type of lithium-ion battery. Renowned for stability, safety, and long cycle life, ...



SMART BMS PROTECTION



LiFePO4 Voltage Charts (1 Cell, 12V, 24V, 48V)

This article will show you the LiFePO4 voltage and SOC chart. This is the complete voltage chart for LiFePO4 batteries, from the individual cell to 12V, 24V, and 48V.

LiFePO4 Float Voltage Guide: What Is It, How to Maximize Battery ...

For a 12V LiFePO4 battery, the ideal float voltage is typically between 13.2V and 13.6V. This breaks down to approximately 3.3V to 3.4V per cell. Setting the float voltage too high (above ...



What is the best float voltage for LiFePO4? , Redway Battery

Optimal Float Voltage for LiFePO4 Batteries. The recommended float voltage for LiFePO4 batteries typically ranges between 3.3V to 3.4V per cell. For a standard 12V LiFePO4 battery pack, ...

LiFePO4 Voltage Charts (1 Cell, 12V, 24V, 48V)

What happens if the float voltage is too high for LiFePO4 batteries? Excessively high float voltage can lead to overcharging, reducing the battery's lifespan and potentially causing safety ...



LiFePO4 Voltage Guide: Charge, Float & Battery Charts

What is the voltage of the LiFePO4



battery? The nominal voltage will vary depending on the lithium battery pack 's cathode material. The nominal voltage of a lithium cobalt oxide battery is ...

The Ultimate Guide to LiFePO4 Float Voltage: Settings for 12V, 24V

What is the optimal LiFePO4 float voltage? Find the exact settings for 12V, 24V, and 48V systems to extend battery life and prevent overcharging.

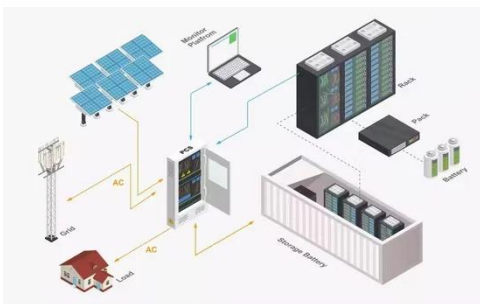
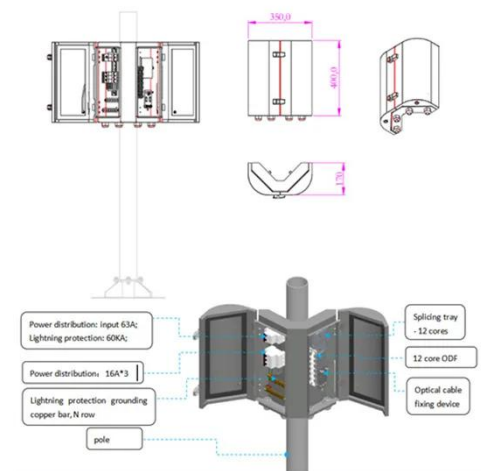

LiFePO4 Battery Float Voltage Settings and Optimization: The ...

Optimizing LiFePO4 battery float voltage is essential for achieving maximum safety, efficiency, and lifespan. By applying the correct voltage range, using compatible equipment, and ...

The Ultimate Guide to LiFePO4 Float Voltage Optimization

What happens if the float voltage is too

high for LiFePO4 batteries? Excessively high float voltage can lead to overcharging, reducing the battery's lifespan and potentially causing safety ...



Optimizing LiFePO4 Float Voltage for Longer Battery Life and ...

Getting the float voltage right is key to maximizing battery performance and safety. The optimal float voltage for a LiFePO4 cell ranges between 3.2V and 3.3V per cell. For a 12.8V (4-cell) ...

Contact Us

For catalog requests, pricing, or partnerships, please visit:
<https://www.peregrine-energy.co.za>

